

SCHEDULE OF ABOVE ROOF BEAMS

BEAM MARKED	BEAM SIZE		TOP REINFORCEMENT		BOTTOM REINFORCEMENT		STIRRUPS (AT SUPPORT)	STIRRUPS (AT SPAN)
	WIDTH (mm)	DEPTH (mm)	ALTHROUGH	EXTRA AT SUPPORT	ALTHROUGH	EXTRA AT SPAN		
SRB-1	250	400	3-16 ϕ	-	3-16 ϕ	-	2L-8 ϕ 100 C/C	2L-8 ϕ 150 C/C
LMRF-1	250	400	3-20 ϕ	2-12 ϕ	3-16 ϕ	2-12 ϕ	2L-8 ϕ 100 C/C	2L-8 ϕ 150 C/C
LMRR-1	250	400	3-16 ϕ	-	3-16 ϕ	-	2L-8 ϕ 100 C/C	2L-8 ϕ 150 C/C
WTB-1	250	400	3-20 ϕ	-	3-20 ϕ	-	2L-8 ϕ 100 C/C	2L-8 ϕ 150 C/C

SLAB THICKNESS - 110 mm (S1)

BAR MKD.	REINFORCEMENT	POSITION
A	8T @ 300 mm C/C (ALL THROUGH)	BOT.
B	8T @ 300 mm C/C (COURTALMENT)	BOT.
C	8T @ 150 mm C/C (COURTALMENT)	TOP
D	8T @ 250 mm C/C (ALL THROUGH)	TOP
X	8T @ 150 mm C/C (ALL THROUGH)	BOT.
Y	8T @ 150 mm C/C (ALL THROUGH)	BOT.
Z	8 ϕ @ 100 mm C/C (COURTALMENT)	TOP

SLAB THICKNESS - 125 mm (S2)

BAR MKD.	REINFORCEMENT	POSITION
A	8T @ 300 mm C/C (ALL THROUGH)	BOT.
B	8T @ 300 mm C/C (COURTALMENT)	BOT.
C	8T @ 150 mm C/C (COURTALMENT)	TOP
D	8T @ 250 mm C/C (ALL THROUGH)	TOP
X	8T @ 150 mm C/C (ALL THROUGH)	BOT.
Y	8T @ 150 mm C/C (ALL THROUGH)	BOT.
Z	8 ϕ @ 100 mm C/C (COURTALMENT)	TOP

SLAB THICKNESS - 150 mm (S3)

BAR MKD.	REINFORCEMENT	POSITION
A	8T @ 300 mm C/C (ALL THROUGH)	BOT.
B	8T @ 300 mm C/C (COURTALMENT)	BOT.
C	8T @ 150 mm C/C (COURTALMENT)	TOP
D	8T @ 250 mm C/C (ALL THROUGH)	TOP
X	8T @ 150 mm C/C (ALL THROUGH)	BOT.
Y	8T @ 150 mm C/C (ALL THROUGH)	BOT.
Z	8 ϕ @ 100 mm C/C (COURTALMENT)	TOP

SLAB THICKNESS - 125 mm (S5)

BAR MKD.	REINFORCEMENT	POSITION
E	10T @ 125 mm C/C (ALL THROUGH)	BOT.
F	10T @ 125 mm C/C (ALL THROUGH)	TOP

SLAB THICKNESS - 200 mm (S4)

BAR MKD.	REINFORCEMENT	POSITION
E	10T @ 150 mm C/C (ALL THROUGH)	BOT.
F	10T @ 150 mm C/C (ALL THROUGH)	TOP

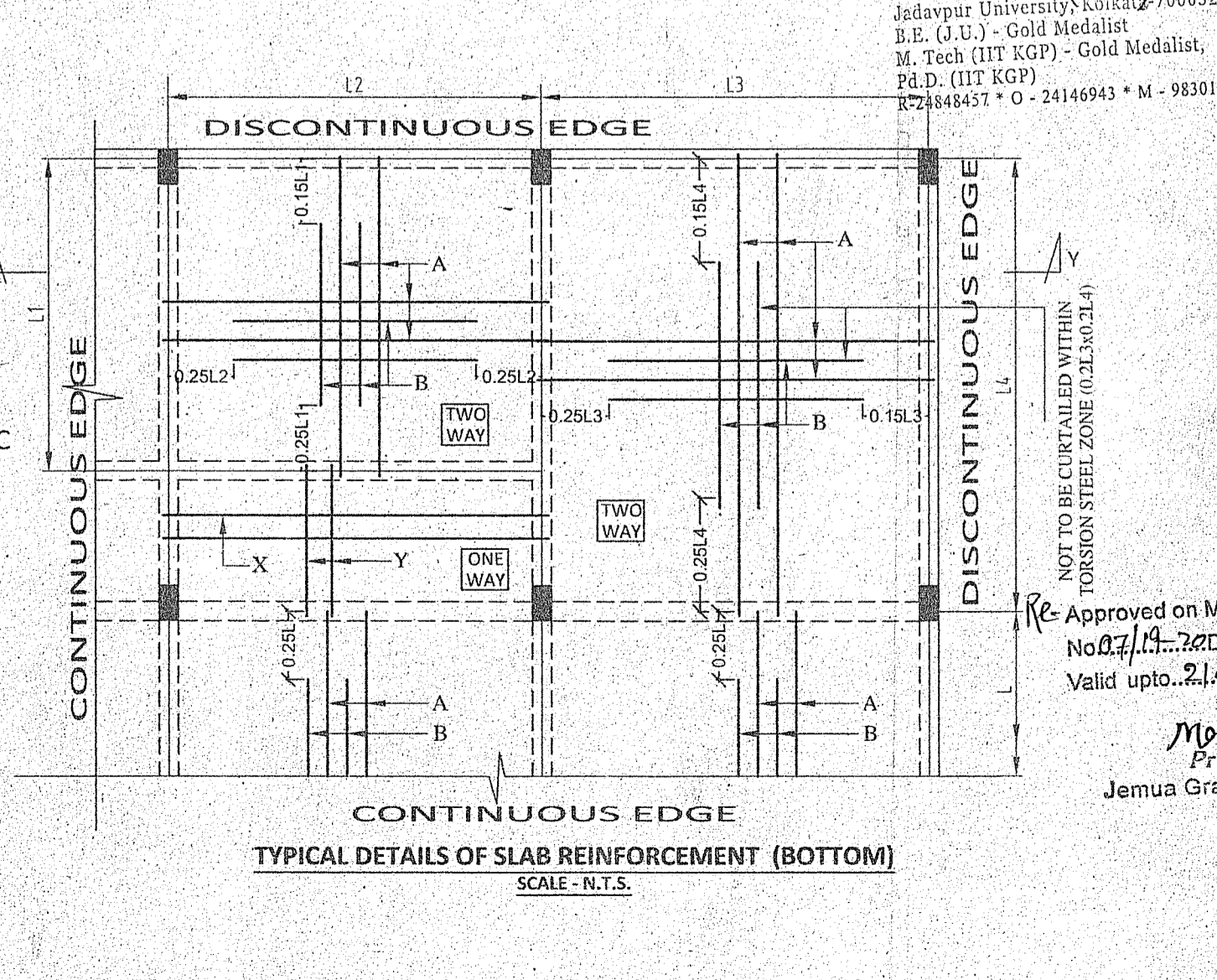
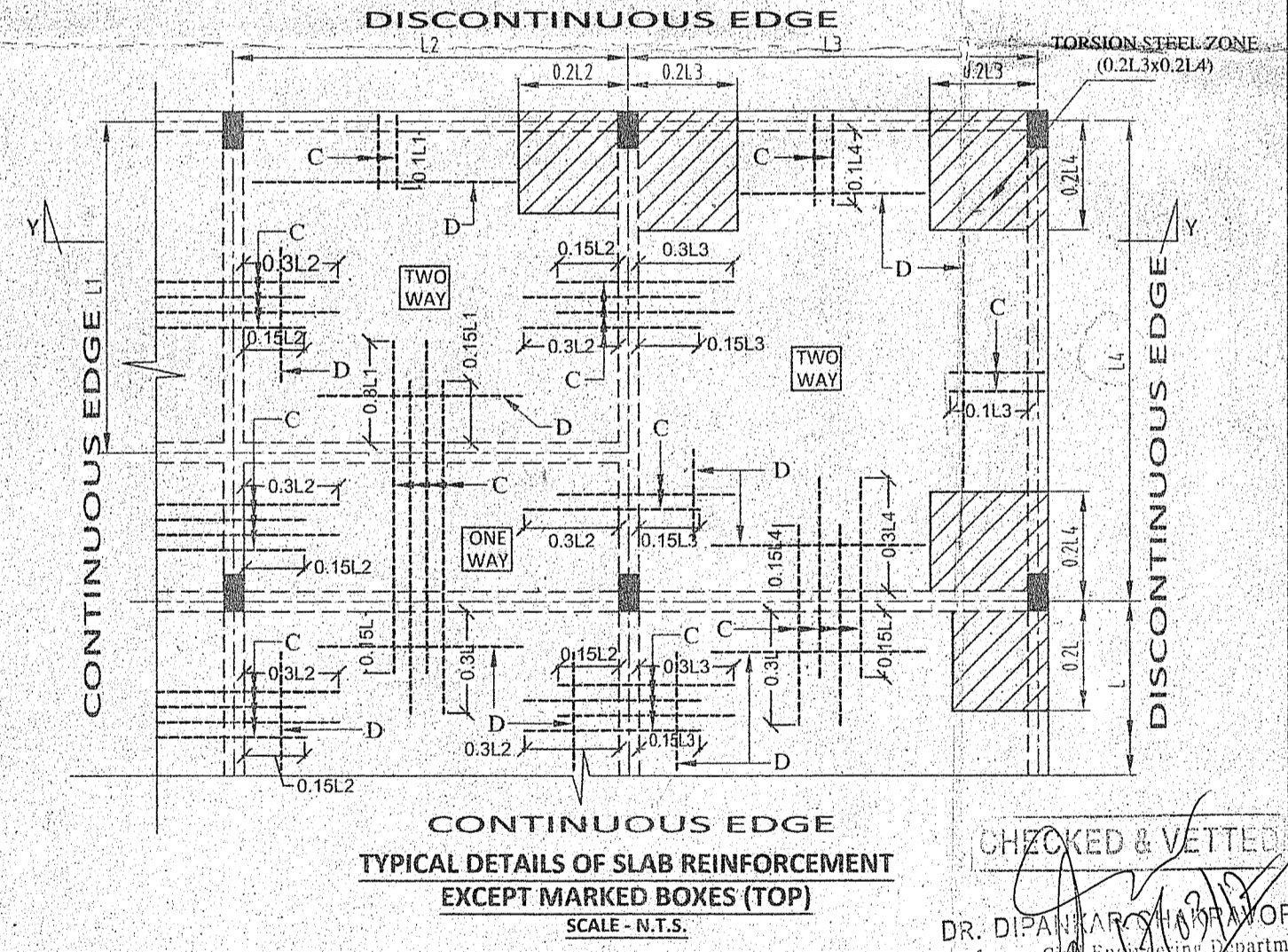
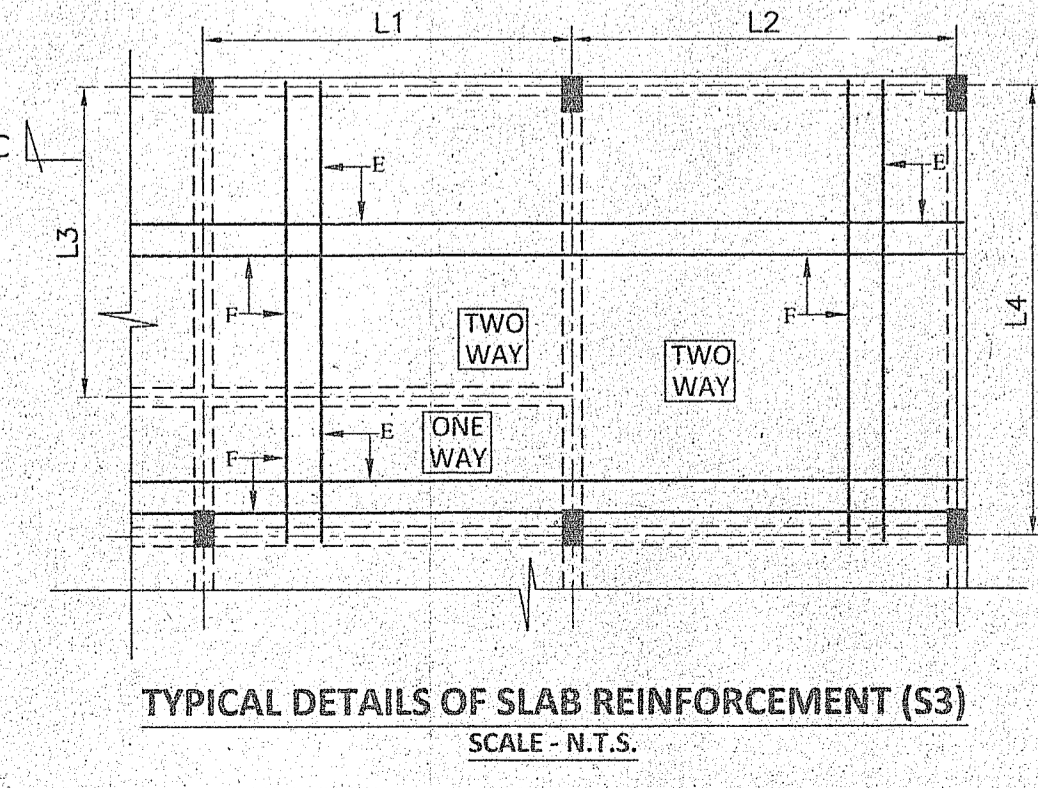
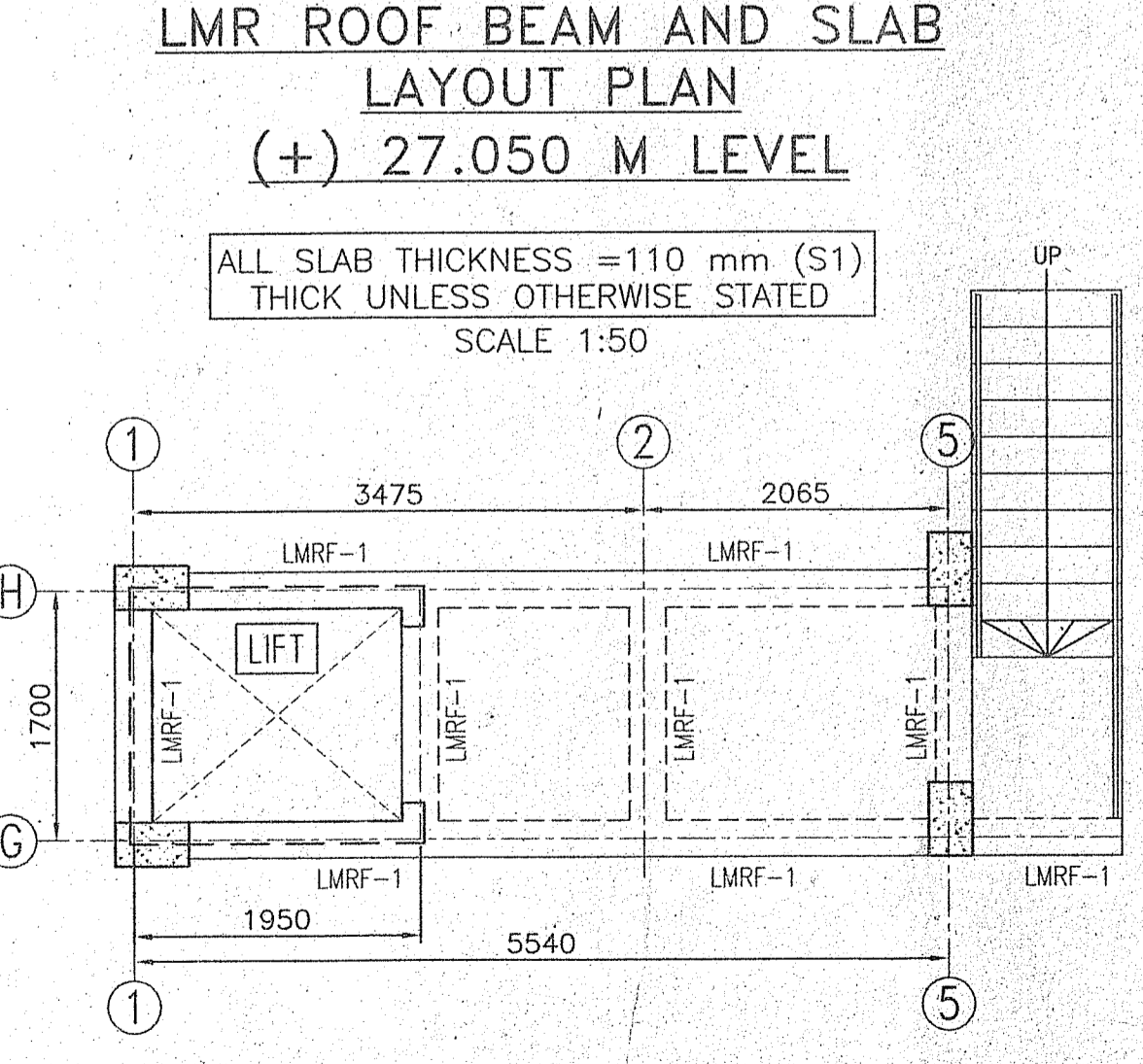
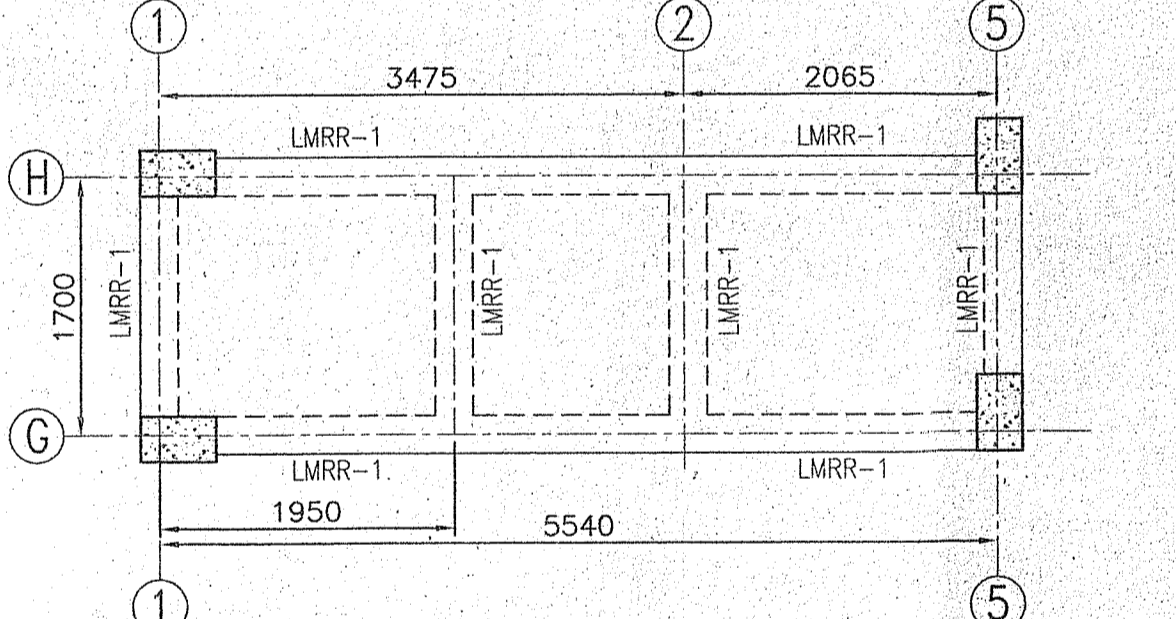
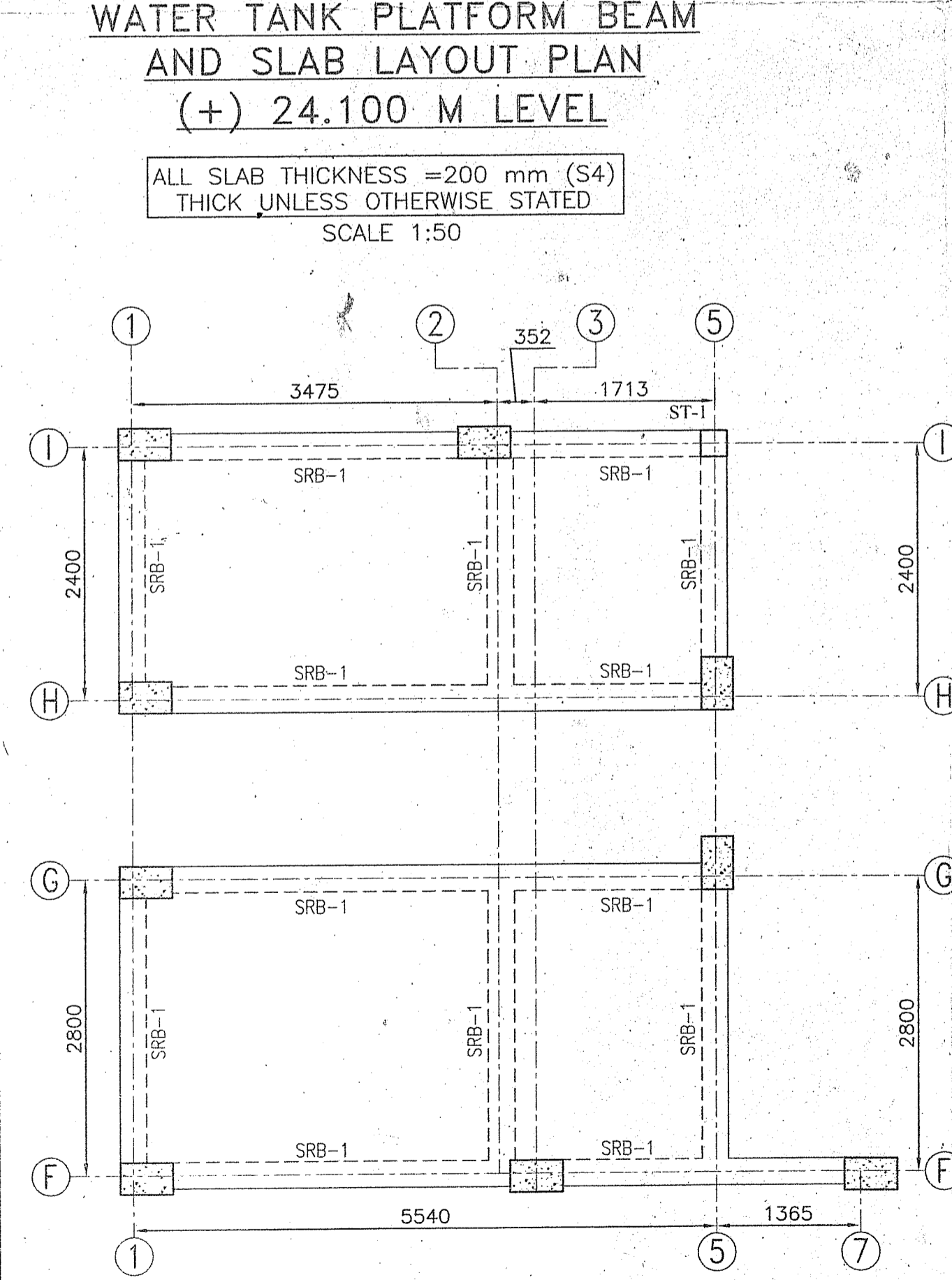

- NOTES:-**
- UNLESS OTHERWISE STATED ALL CONSTRUCTION ACTIVITIES SHALL BE CARRIED OUT CONFORMING TO RELEVANT (INDIAN) STANDARD CODES OF PRACTICE.
 - ALL DIMENSIONS ARE IN MILLIMETERS & LEVELS ARE IN METER. EXCEPT OTHERWISE MENTIONED ONLY WRITTEN DIMENSIONS SHALL BE FOLLOWED. ALL LEVELS GIVEN IN STRUCTURAL DRAWINGS ARE IN ACCORDANCE WITH ARCHITECTURAL DRAWINGS. AND INDICATE STRUCTURAL LEVEL ONLY (WITHOUT FINISH). HOWEVER ARCHITECTURAL DRAWING TO BE COORDINATED FOR ALL LEVELS.
 - ALL STRUCTURAL DRAWINGS SHALL BE READ ALONG WITH THIS DRAWING AS WELL AS RELEVANT ARCHITECTURAL DRAWINGS.
 - ANY DISCREPANCY IN THE STRUCTURAL AND ARCHITECTURAL DRAWINGS SHALL BE BROUGHT TO THE NOTICE OF STRUCTURAL CONSULTANT BEFORE EXECUTION OF WORK.
 - UNLESS OTHERWISE SPECIFIED ALL REINFORCEMENT TO BE USED SHALL BE TMT. BARS OF GRADE Fe-500/500 D CONFORMING TO IS-1786-2008.
 - ADEQUATE CHAIR BARS TO BE PROVIDED TO KEEP THE TOP REINFORCEMENT IN PROPER POSITION.
 - UNLESS OTHERWISE STATED LAP LENGTH OF BARS SHALL BE DEVELOPMENT LENGTH = 50x BAR DIA.
 - UNLESS OTHERWISE SPECIFIED DISTRIBUTION REINFORCEMENT SHALL BE 8T @ 250 C/C.
 - CONCRETE COVER TO MAIN REINFORCEMENT SHALL BE AS FOLLOWS:
 - i) COLUMNS : 40 MM
 - ii) SLAB : 20 MM
 - iii) BEAM : 25 MM
 - GRADE OF CONCRETE FOR BEAMS, SLABS AND STAIRCASE SHALL BE AS FOLLOWS FOUNDATION TO 4TH FLOOR - M30 4TH FLOOR TO ROOF - M25
 - DEVELOPMENT LENGTH 50xD FOR LAP & SPICES SHOULD BE PROVIDED AS PER THE PROVISIONS LAID DOWN IN SP34:1987
 - WHREVER A SUPPORTED MEMBER TERMINATES AT A SUPPORTING MEMBER THE BARS OF THE SUPPORTED MEMBER SHOULD HAVE AN ANCHORAGE OF 50D IN THE SUPPORTING MEMBER DRAWING.

TITLE

PROPOSED STRUCTURAL DRAWING OF G+7 (EIGHT STORIED) STORIED APARTMENT BUILDING FOR ABHENANDAN REAL INFRA VENTURES LLP. OVER R.S. PLOT NO. - 125(P), L.R. PLOT NO. - 379, 388, R.S. KHATIAN NO. - 339, L.R. KHATIAN NO. - 2214, MOUZA - SANKARPUR, J.L. NO. - 109, P.S. - NEWTOWNSHIP, DIST. - BURDWAN

CERTIFICATE OF STRUCTURAL ENGINEER

THE STRUCTURAL DESIGN AND DRAWING OF BOTH FOUNDATION AND SUPERSTRUCTURE OF THE BUILDING HAS BEEN MADE BY ME, CONSIDERING ALL POSSIBLE LOADS INCLUDING THE SEISMIC LOAD AS PER THE NATIONAL BUILDING CODE OF INDIA AND CERTIFIED THAT IT IS SAFE & STABLE IN ALL RESPECT.

CERTIFICATE OF ARCHITECT/ENGINEER

I DO HEREBY CONFIRM AND CERTIFY WITH FULL RESPONSIBILITY THAT THE BUILDING PLAN HAS BEEN PREPARED BY ME KEEPING THE PROVISION OF NBC OF INDIA AND CERTIFY THAT IT IS SAFE & STABLE IN ALL RESPECT.

Susmita Choudhury
12/2019
SUSMITA CHOUDHURY
CIVIL ENGINEER (B.Tech)
W.B.U.T

CERTIFICATE OF GEOTECHNICAL ENGINEER

THIS IS TO CERTIFY THAT THE SOIL TEST HAS BEEN PERFORMED BY ME FOR THIS PROJECT

Vijaya Singh
VIJAYA SINGH
Consulting Architect
DMC Registered
LIC No.-DMC/BPD/60

Samba Chakraborty
SAMBA CHAKRABORTY
CONSULTING ARCHITECT
CA/2010/48894

CHECKED & VETTED

DR. DIPANBAR MOHANTY
Professor, Civil Engineering Department,
Jadavpur University, Kolkata-700032
B.E. (J.U.) - Gold Medalist
M. Tech (IIT KGP) - Gold Medalist,
P.D. (IIT KGP)
12345678910 - 24146943 * M - 9830188502

ALOK ROY
Empanelled Geotechnical Engineer
Kolkata Municipal Corporation
Class-I, No. - G.17/11
6A, Milan Park,
Kolkata-700 084

CERTIFICATE OF OWNER

THIS IS TO CERTIFY THAT I SHALL NOT ON A LATER DATE, MAKE ANY ADDITION OR ALTERATION TO THIS PLAN. THIS IS CERTIFIED THAT I HAVE GONE THROUGH THE NBC OF INDIA AND ALSO ABIDE BY THOSE RULES DURING AND LATER CONSTRUCTION OF BUILDING.

ABHENANDAN REAL INFRA VENTURES LLP
Pratik Kumar
PARTNER

SIGNATURE OF PANCHAYAT PRADHAN

Approved on Meeting No. 02/14 Date: 2.2.2019 Valid upto: 2.11.2021

Malika Pohan
Pradhan
Jemua Gram Panchayat

Approved on Meeting No. 02/14 Date: 21/02/2019 Valid upto: 18/01/2019

Malika Pohan
Pradhan
Jemua Gram Panchayat

DRAWING TITLE:
DETAIL OF STAIR & SLAB REINFORCEMENT DETAILS

SHT. SIZE SHEET NO. REV. R-0 R-1 DWG. NO.
A1 4 OF 4 DATE 10.02.17 15.03.17 SE/ST/ABH/16-17/01